

- 1440 JEWELERS ON FIFTH
 A- JEWEL SHOP
 B- JEWELS & DIAMONDS
 C- DIAMOND CROWN
 D- ROYAL JEWELRY
 E- MODERN DESIGNS
 F- OSCAR JEWELRY
 G- ELEGANT CREATIONS
 H- GABRIEL JEWELERS II
 I- JEWELRY COUTURE
 J- BIG APPLE DESIGNS
 K- ICE KINGS
 L- MICHAEL'S JEWELRY REPAIR
 M+N- PATRICIO REPAIRS

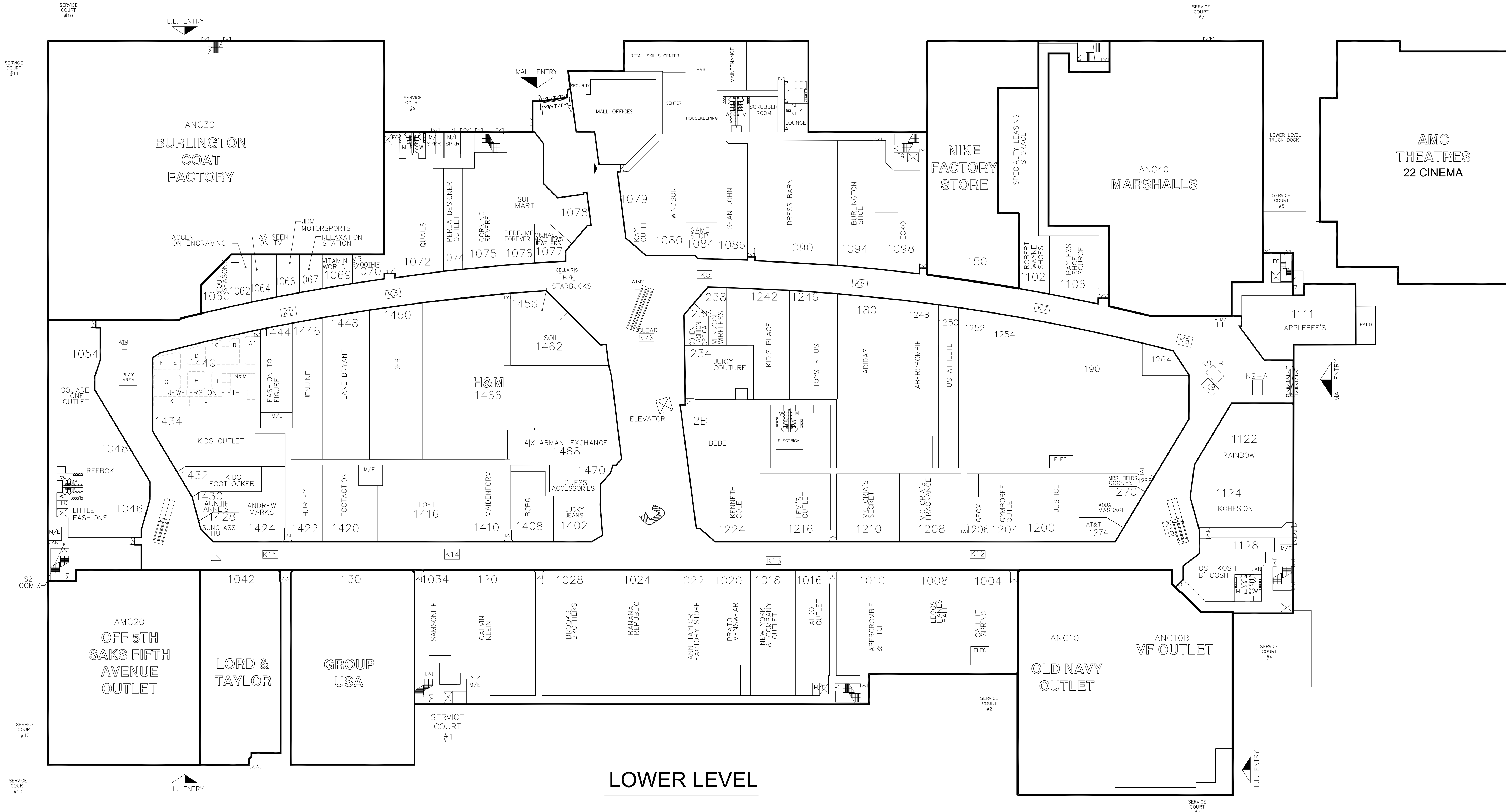

LOWER LEVEL

Jersey Gardens
 Elizabeth, New Jersey

GLIMCHER
 DEVELOPMENT CORPORATION
 GLIMCHER PROPERTIES LIMITED PARTNERSHIP
 180 East Broad Street, 21st Floor
 Columbus, OH 43215
 Phone: 614.621.9000
 Fax: 614.621.9321

Revisions

No.	Date
1	

GROSS LEASABLE AREA:
 Mall Shop GLA:

- Anchors:
- 1) BED BATH BEYOND
 - 2) BURLINGTON
 - 3) COHOES FASHION
 - 4) DAFFY'S
 - 5) FILENE'S
 - 6) GAP OUTLET
 - 7) GROUP USA
 - 8) JEEPERS!
 - 9) LAST CALL
 - 10) LOEWS THEATRES
 - 11) MARSHALLS
 - 12) MODELL'S
 - 13) NIKE FACTORY
 - 14) OFF 5TH SAKS
 - 15) OLD NAVY

Out Parcel
 Total GLA:

WEB-MLP-LL-11Q4
 1" = 50'-0"

10.01.11
 1101

All of the tenant names which are indicated on this plan represent those leases which are executed, out for signature, in negotiation or proposed. All tenancies specified may not actually come into existence. All square footages and dimensions are approximate and subject to field verification.

Jersey Gardens

Elizabeth, New Jersey

GLIMCHER
DEVELOPMENT CORPORATION

GLIMCHER PROPERTIES LIMITED PARTNERSHIP
180 East Broad Street, 21st Floor
Columbus, OH 43215
Phone: 614.621.9000
Fax: 614.621.9321

Revisions	
No.	Date
1	

GROSS LEASABLE AREA:
Mall Shop GLA:

- Anchors:
- 1) BED BATH BEYOND
 - 2) BURLINGTON
 - 3) COHOES FASHION
 - 4) DAFFY'S
 - 5) FILENE'S
 - 6) GAP OUTLET
 - 7) GROUP USA
 - 8) JEEPERS!
 - 9) LAST CALL
 - 10) LOEWS THEATRES
 - 11) MARSHALLS
 - 12) MODELL'S
 - 13) NIKE FACTORY
 - 14) OFF 5TH SAKS
 - 15) OLD NAVY

Out Parcel
Total GLA:

WEB-MLP-UL-11Q4
1" = 50'-0"

10.01.11
1101

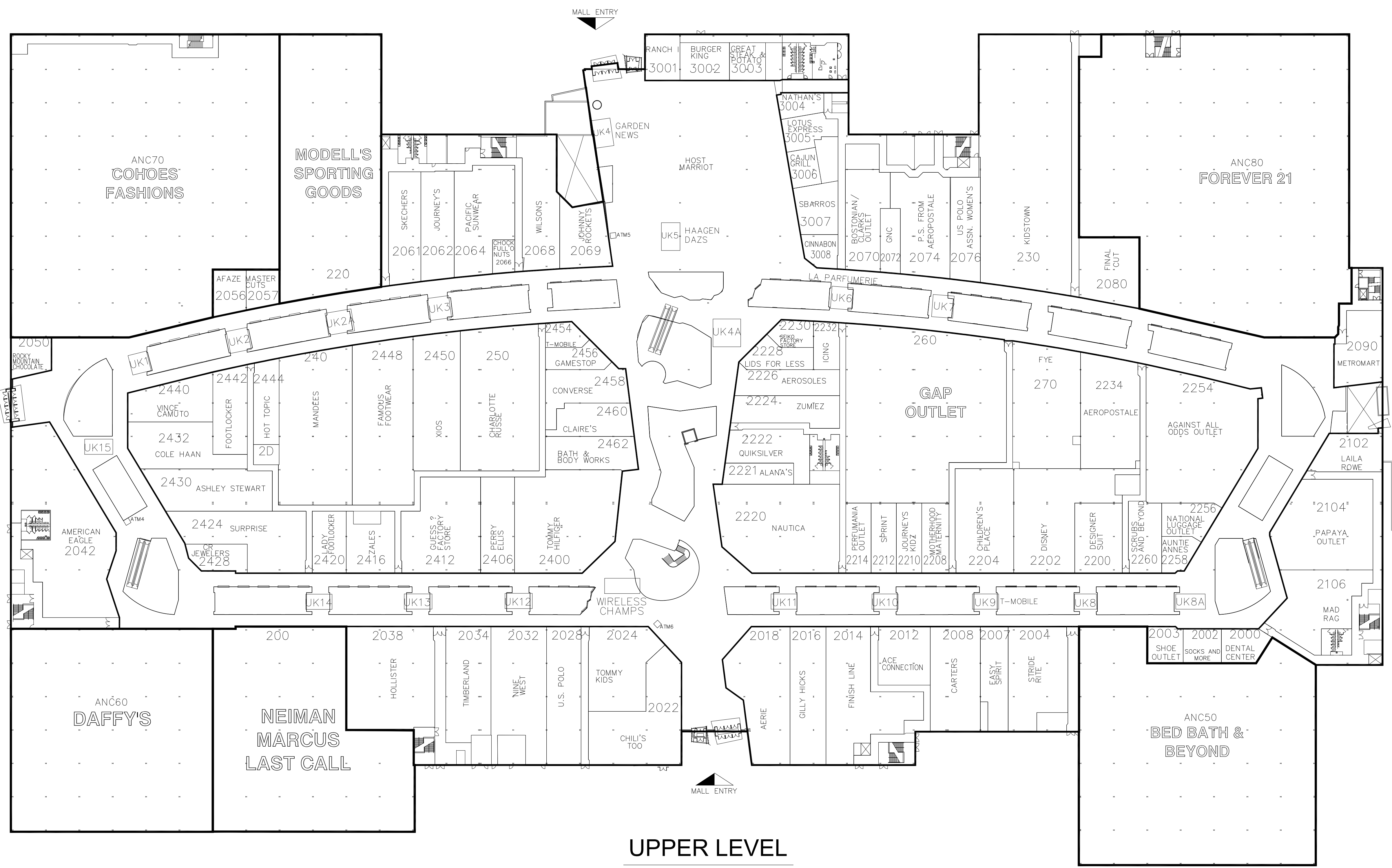

UPPER LEVEL

All of the tenant names which are indicated on this plan represent those leases which are executed, out for signature, in negotiation or proposed. All tenancies specified may not actually come into existence. All square footages and dimensions are approximate and subject to field verification.

